

měřítko 1 : 200  
aktualizováno - 02 / 2017

The diagram illustrates the spatial arrangement of a dental chair and its associated equipment. Key components and their labels are as follows:

- ŽENSKÁ KLINIKA**: Located at the top left, indicating the gender of the patient.
- Z**: A label pointing to a vertical component, likely a Z-axis adjustment mechanism.
- STRAVOVACÍ PROVOZ**: Located at the top right, indicating the food service area.
- SVLS**: A label pointing to a component on the left side, likely a vertical lift system.
- CH**: A label pointing to a central component, likely a chair headrest or backrest.
- část SEVER**: A label pointing to the left side of the chair, indicating the northern part.
- L**: A label pointing to a circular component, likely a light or a control knob.
- část JIH**: A label pointing to the right side of the chair, indicating the southern part.
- LŮŽKOVÝ TRAKT**: A label pointing to the lower part of the chair, indicating the bed track.
- PATOLOGIE**: Located at the bottom left, indicating the pathology area.
- I1** and **I2**: Labels pointing to components at the bottom, likely indicating specific points or axes.
- TT0**: A label at the bottom right, likely indicating a specific point or axis.

GEK / HEMODIALÝZA

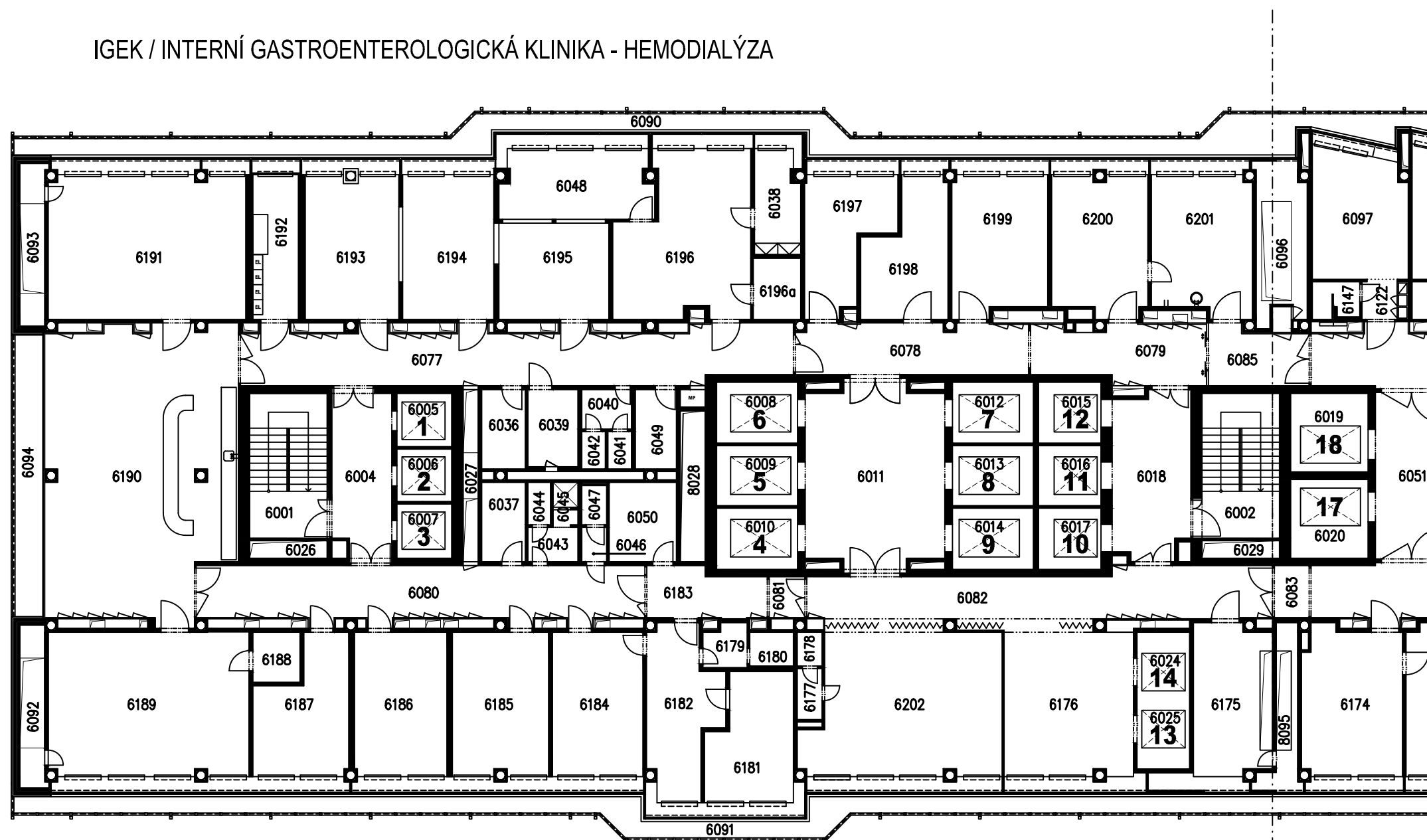

ČEKÁRNA

ČÁST - SEVER  
-----  
ČÁST - JIH